

Neutral Gear Sensor

A PLCD (Permanent Magnet Linear Contactless Displacement) sensor is introduced on Stop/Start vehicles and located on the exterior of the transmission casing and hardwired to the ECM. The sensor's function is to detect that neutral gear has been selected within a calibrated window.

For additional information, refer to: [Starting System](#) (303-06C Starting System - TD4 2.2L Diesel, Vehicles Built From: 01-03-2009, Description and Operation).

Shift Control Mechanism

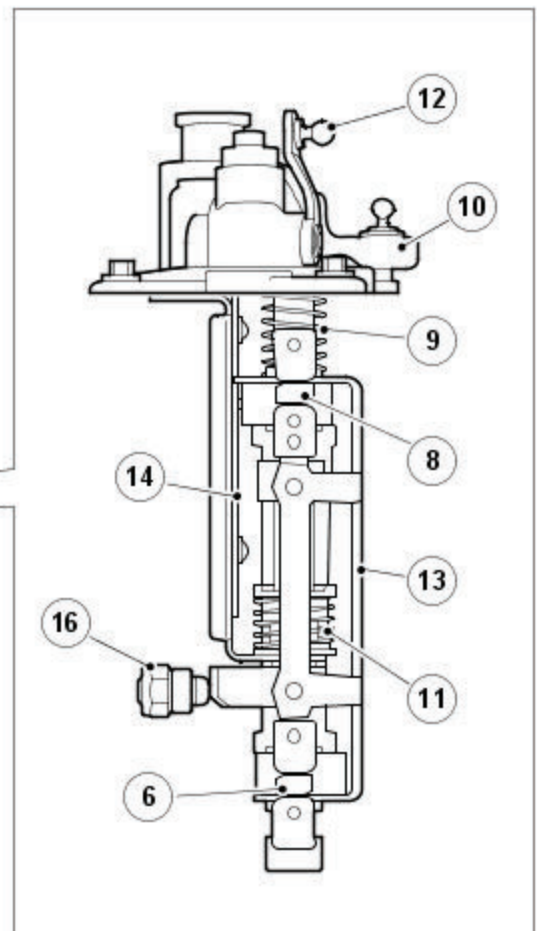
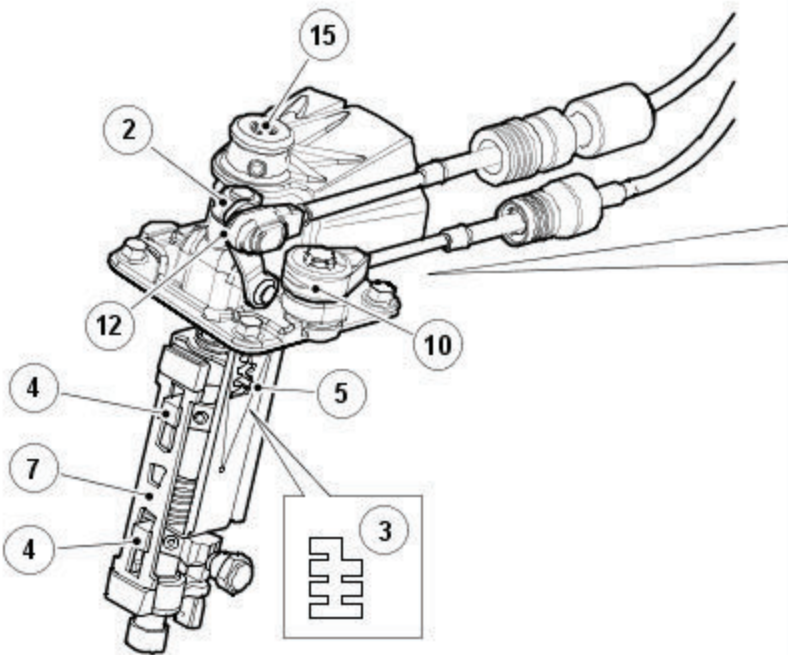
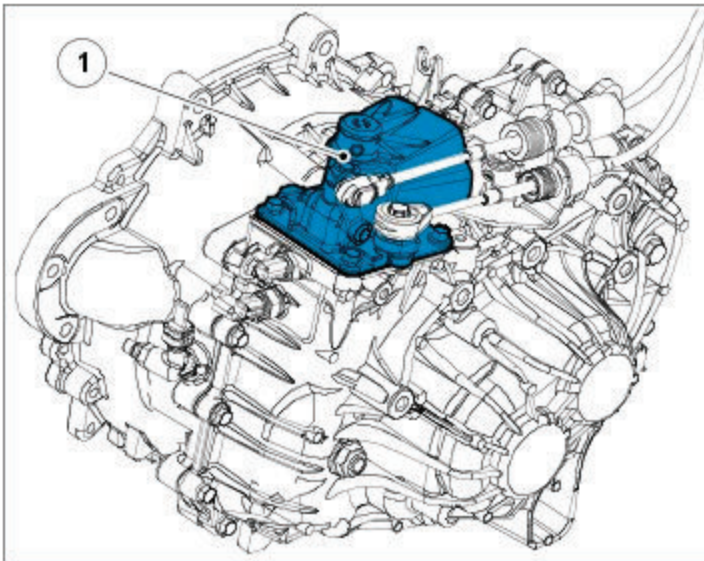

E77243

Item	Part Number	Description
1	-	Shift control mechanism
2	-	Ball limiter 5th - 6th gear control
3	-	Gearshift gate
4	-	Flange
5	-	Gear shift gate pin
6	-	Lower gear selector
7	-	Gear selector rod
8	-	Upper gear selector
9	-	Spring
10	-	Longitudinal lever
11	-	Spring
12	-	Lateral lever
13	-	Catch plate
14	-	Carrier plate
15	-	Bleed cap